

# Steam Traps

## FTV-270 1 1/2" & 2"

### Float & Thermostatic Traps



FTV-270 is a Ball float steam trap designed to remove condensate from steam and it is recommended for high condensate flow equipments such as evaporators, drying cylinders, air dryers, etc. It can be supplied with Air Vent (EAR) Release as standard or Steam Lock Release (SLR) as optional. It can be easily maintained even when installed, its discharge orifices below the condensate level of steam trap prevent trap against live steam leakage. It can be supplied with screwed connections NPT (ANSI-B1.20.1). Flanges according to ANSI-B16.5 class. Contact factory for other connection options.



#### FEATURES

Product Family	<b>FTV-270</b>
Sizes	<b>1 1/2" and 2"</b>
Connections	<b>Screwed, Flanged</b>
Body Material	<b>GGG 40.3 Ductile Iron</b>
Options	<b>SLR - Steam Lock Release</b>
PMO Max. Oper. Pressure	<b>250 psig</b>
TMO Max. Oper. Temperature	<b>425 °F</b>

#### AVAILABLE MODELS

FTV-271: Max. differential pressure 200 psig

FTV-272: Max. differential pressure 145 psig

FTV-273: Max. differential pressure 65 psig

#### HOW TO ORDER

Specify:

- Model
- Sizes and type of connection

**Example:** (1) SF Thermaflo model FTV271 Float and Thermostatic Steam Trap with npt end connections .

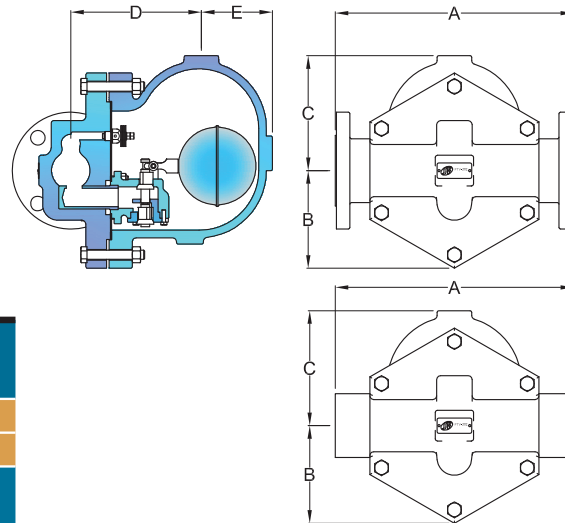

#### DIMENSIONS & WEIGHT (INCHES & POUNDS)

DN	A	B	C	D	E	Weight	
1 1/2"	10.63	4.65	5.31	6.38	3.35	44.09	
2"	11.89	5.00	5.91	6.61	3.62	66.14	
DN	A		B	C	D	E	Weight
	150#	300#					
1 1/2"	12.28	12.28	4.65	5.31	6.38	3.35	44.09
2"	12.64	12.87	5.00	5.91	6.61	3.62	66.14

#### CAPACITY

Model	Sizes	Orifices	DIFFERENTIAL PRESSURE - ΔP (psig) x Q (lb/h)											
			10	15	20	30	40	50	60	70	80	90	100	
FTV-271	1 1/2"	0.50 / 0.53	418	627	836	1,254	1,672	2,090	2,508	2,926	3,344	3,762	4,180	4,598
FTV-271	2"	0.69 / 0.71	567	850	1,133	1,700	2,267	2,834	3,401	3,968	4,535	5,102	5,669	6,236
FTV-272	1 1/2"	0.56 / 0.60	457	686	915	1,372	1,829	2,286	2,743	3,200	3,657	4,114	4,571	5,028
FTV-272	2"	0.81 / 0.85	611	917	1,223	1,834	2,445	3,056	3,667	4,278	4,889	5,500	6,111	6,722
FTV-273	1 1/2"	0.68 / 0.75	521	782	1,043	1,564	2,085	2,606	3,127	3,648	4,169	4,690	5,211	5,732
FTV-273	2"	1.06 / 1.10	701	1,052	1,403	2,104	2,805	3,506	4,207	4,908	5,609	6,310	7,011	7,712

## FTV-270 1 1/2" & 2"

### Float & Thermostatic Traps

#### COMPONENTS AND MATERIALS

Pos.	Description	Material
1	Air Vent Bimetal	AISI 304 SS
2	Steam Lock Release	AISI 304 SS
3	Head Screw	Carbon Steel 8.8 fosfate
4	Float Assy	AISI 304 SS
5	Gasket	Non asbestos
6	Body	GGG 40.3 Ductile Iron
7	Cover	GGG 40.3 Ductile Iron
8	Mechanism Assy	AISI 304 SS

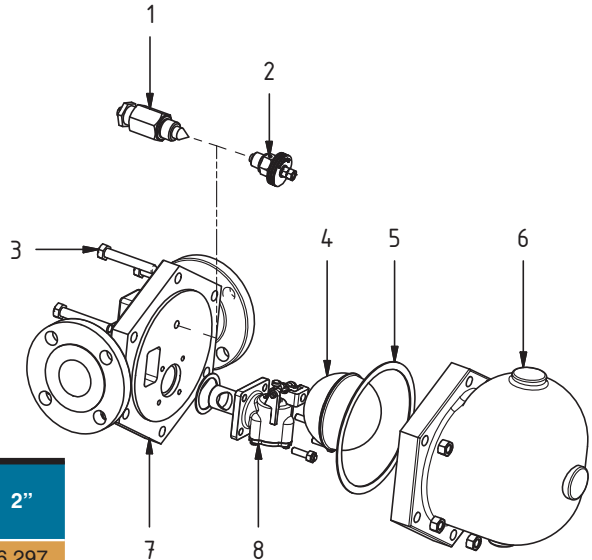

#### HOW TO ORDER SPARE PARTS

Model	Description	Part	1 1/2"	2"
FTV271	Mechanism	8	6,296	6,297
	Float	4	6,303	6,303
	Gasket	5	6,310	6,310
	Air Vent Assy	1	2,320	2,320
	Steam Lock Release Assy	2	6,322	6,308
FTV272	Mechanism	8	6,298	6,299
	Float	4	6,303	6,303
	Gasket	5	6,310	6,310
	Air Vent Assy	1	2,320	2,320
	Steam Lock Release Assy	2	6,322	6,308
FTV273	Mechanism	8	6,300	6,301
	Float	4	6,303	6,303
	Gasket	5	6,310	6,310
	Air Vent Assy	1	2,320	2,320
	Steam Lock Release Assy	2	6,322	6,308

#### TYPICAL INSTALLATION

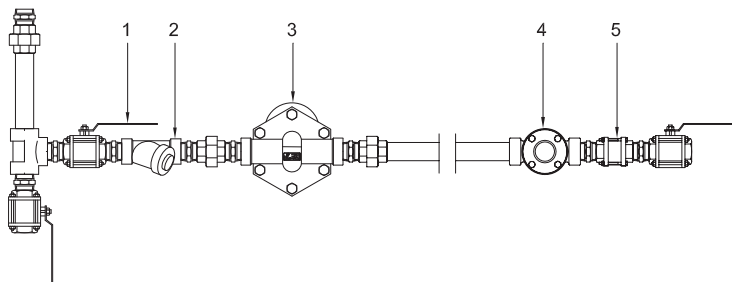

Title:	
1	Stop Valve
2	Y Strainer
3	Steam Trap
4	Sight Glass
5	Check Valve

#### PRODUCT DISPOSAL

This product is totally recyclable. No ecological hazard is anticipated with the disposal of this product.

#### SAFETY, INSTALLATION AND MAINTENANCE

For safety, installation and maintenance information see instructions supplied with the product (MI-0102-46).